

WA8021V5
V500R019C30

Quick Start

Issue 04
Date 2020-02-18



Copyright © Huawei Technologies Co., Ltd. 2020. All rights reserved.

No part of this document may be reproduced or transmitted in any form or by any means without prior written consent of Huawei Technologies Co., Ltd.

Trademarks and Permissions



HUAWEI and other Huawei trademarks are trademarks of Huawei Technologies Co., Ltd.

All other trademarks and trade names mentioned in this document are the property of their respective holders.

Notice

The purchased products, services and features are stipulated by the contract made between Huawei and the customer. All or part of the products, services and features described in this document may not be within the purchase scope or the usage scope. Unless otherwise specified in the contract, all statements, information, and recommendations in this document are provided "AS IS" without warranties, guarantees or representations of any kind, either express or implied.

The information in this document is subject to change without notice. Every effort has been made in the preparation of this document to ensure accuracy of the contents, but all statements, information, and recommendations in this document do not constitute a warranty of any kind, express or implied.

Huawei Technologies Co., Ltd.

Address: Huawei Industrial Base
Bantian, Longgang
Shenzhen 518129
People's Republic of China

Website: <https://www.huawei.com>

Email: support@huawei.com

Contents

1 Product Overview.....	1
2 Working as a Router.....	3
3 Working as a Wi-Fi repeater.....	7
4 Parameter.....	11
5 FAQs.....	12

1 Product Overview

The WA8021V5 is a home edge ONT that provides gigabit dual-band Wi-Fi and gigabit network ports.

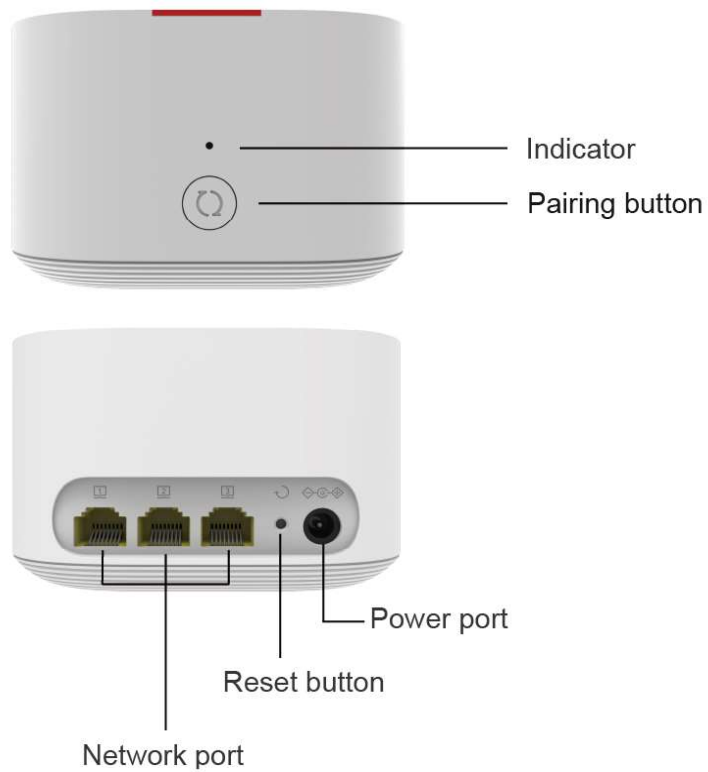

NOTE

- This product is used indoors only.
- The product appearance shown in this document is for your reference only. The actual product appearance prevails.

Description of ports and buttons

WA8021V5	Description
Network port	Adaptive to the LAN port or WAN port: Connects to the gateway as a WAN port, or connects to devices such as computers and IP STBs as a LAN port.
Power port	Connects to a power adapter.
Pairing button	When the edge ONT has detected a device that can be paired, press the pairing button on the edge ONT and release it. The indicator blinks quickly. The device that can be paired connects to the Wi-Fi of the edge ONT.
	When connecting to other device in WPS mode, press the pairing button on the edge ONT for 3 seconds. If the indicator blinks quickly, the device is performing WPS pairing.
Reset button	Press and hold the Reset button of the device for more than 2 seconds using a needle, and release the button after the indicator turns off. After the device restarts and the red indicator turns on, the factory settings are restored.

Description of Indicator

Status	Description
White: steady on	Internet access is available.
Red: steady on	Internet access is unavailable. 1. The edge ONT is being powered on. 2. The edge ONT is not connected to the upstream gateway.
Red: Blinking slowly (once per second)	The edge ONT has detected a device that can be paired.
Red: Blinking quickly (twice per second)	The edge ONT is being paired with Huawei gateway in one-click mode.
	The edge ONT is performing WPS pairing.

2 Working as a Router

If there is no router at home, it is recommended that the WA8021V5 be used as a router.

NOTE

After being connected to a Huawei gateway of a certain model using a network cable, an edge ONT automatically adapts itself as a Wi-Fi repeater. The Wi-Fi name and password are automatically synchronized from the Huawei gateway. You can access the Internet instantly without configuring the Wi-Fi name and password.

1. Connect cables.

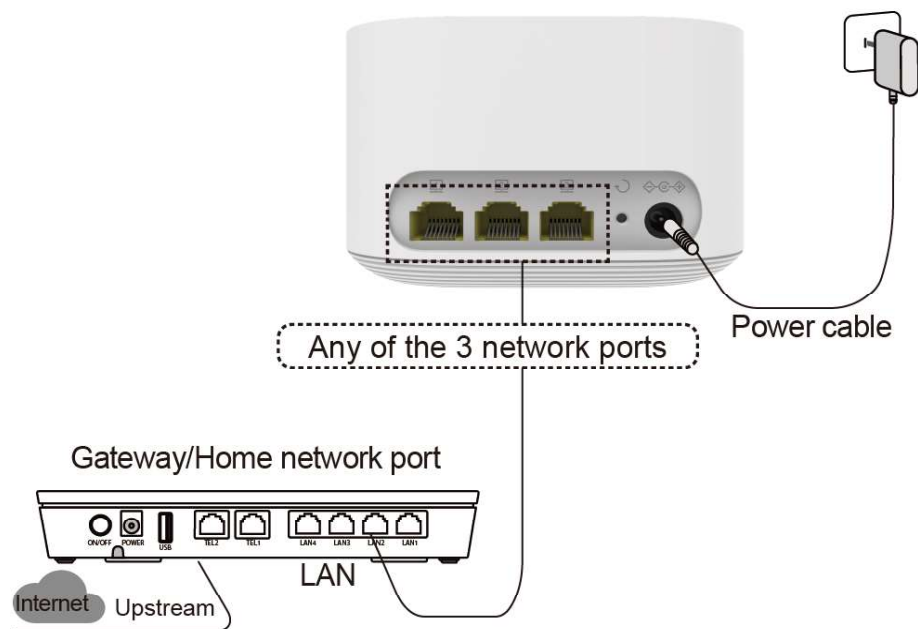

2. Connect a phone or PC to the Wi-Fi of the edge ONT (no password). For the Wi-Fi name, see the SSID on the device nameplate.

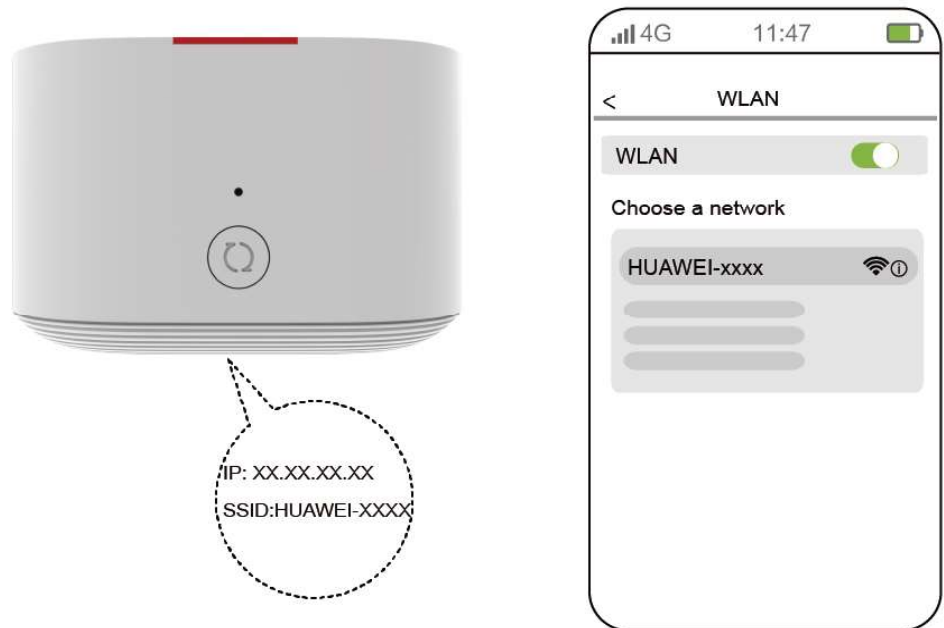

NOTE

You can also use a network cable to connect a PC to the edge ONT, and then set the Internet access mode on the PC.

3. Open the browser. The configuration page is automatically displayed. Click **Start**, the edge ONT will automatically detect your Internet access mode.

NOTE

1. Some mobile phones automatically display the configuration page following the Wi-Fi connection page.
2. If the configuration page is not automatically displayed, enter the IP address in the address box of a browser. (For details about the IP address, see the product nameplate.)
3. If the device detects that the Internet access mode is dial-up, you need to enter the broadband account and password. If you forget the broadband account and password, contact your ISP to retrieve the account and password.
4. On the **Service Provider Remote Management Platform** page, the **Server address** field is automatically populated after you select an **Area**. You can also manually enter a **Server address**. Then select the privacy statement, and click **Apply** to enable the function of service provider remote management.

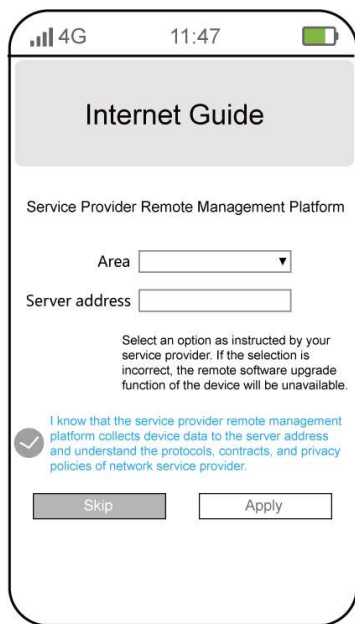

NOTE

- This step applies only to general products. Skip this step if it is not displayed on the product page.
 - Select an option as instructed by your service provider. If you do not select an option or select an incorrect option, the remote software upgrade will be unavailable. You can also click **Skip**, and configure this option on the **Service Provider Remote Management Platform** page later.
5. Set a new Wi-Fi SSID and management password of the edgem ONT. You can use the Wi-Fi password as the device management password. Click **Next**. After the configuration is complete, reconnect to Wi-Fi.

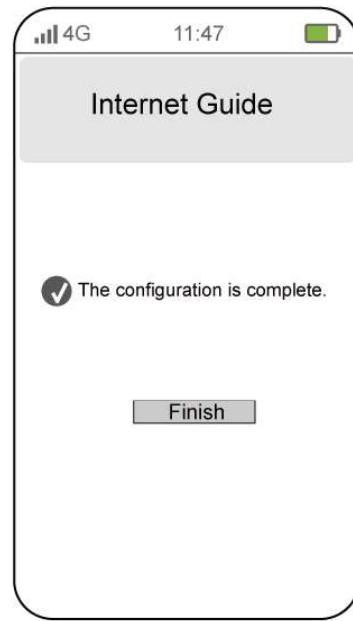

 **NOTE**

1. If band steering is enabled, 2.4 GHz Wi-Fi and 5 GHz Wi-Fi are both supported, and the edge ONT automatically selects a faster Wi-Fi frequency band for you.
2. You can connect devices such as PCs to other network ports of the edge ONT using network cables to access the Internet.

3 Working as a Wi-Fi repeater

If you need to extend the existing Wi-Fi, you can use the WA8021V5 as a Wi-Fi repeater to expand Wi-Fi coverage.

Method 1: One-Click Pairing (Used Together with a Huawei Gateway*)

*Applicable to connection with Huawei gateways with the latest software version (for details, contact the service provider).

1. Place the edge ONT near a Huawei gateway (within 2 m) and connect the power cable of edge ONT to a socket.
2. After the edge ONT is powered on, the Huawei gateway can discover edge ONT, and the WPS indicator of the gateway blinks slowly.
3. Press the WPS button of the gateway once. The WPS indicator and edge ONT indicator change to blink quickly.

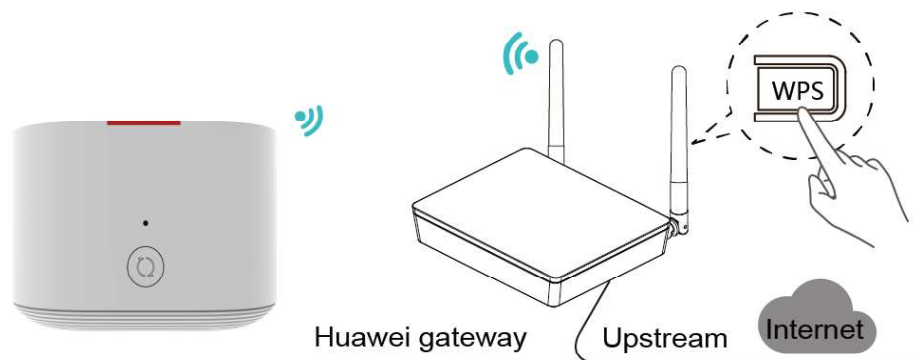

4. Wait until the edge ONT indicator turns steady white, which indicates that the pairing is successful.

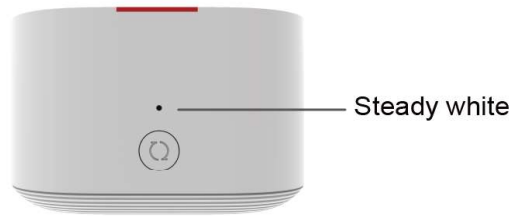

5. Move the edge ONT to the position where the Wi-Fi coverage is to be expanded. After the indicator is steady white, the edge ONT can access the Internet. No further operation is required.

NOTE

1. The Wi-Fi name and password of the edge ONT are automatically synchronized from the Wi-Fi of the Huawei gateway.
2. You can connect devices such as PCs to network ports of the edge ONT using network cables to access the Internet.
3. To achieve better signal coverage, it is recommended that:
 - There are no more than two walls between edge ONTs and the Huawei gateway.
 - Edge ONTs and the Huawei gateway are placed on the same floor.

Method 2: Setting the Internet Access Mode on a Mobile Phone or PC

1. Connect a phone or PC to the Wi-Fi of the edge ONT (no password). For the Wi-Fi name, see the SSID on the device nameplate.

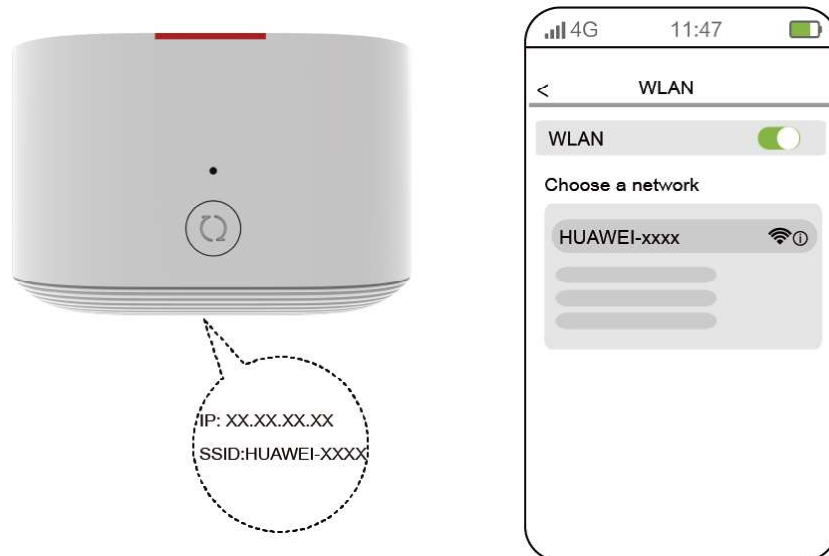

NOTE

- You can also use a network cable to connect a PC to the edge ONT, and then set the Internet access mode on the PC.
2. Open the browser. The configuration page is automatically displayed. Click **Start**, the edge ONT will automatically detect your Internet access mode. If no network cable is inserted, select **Wi-Fi relay**.

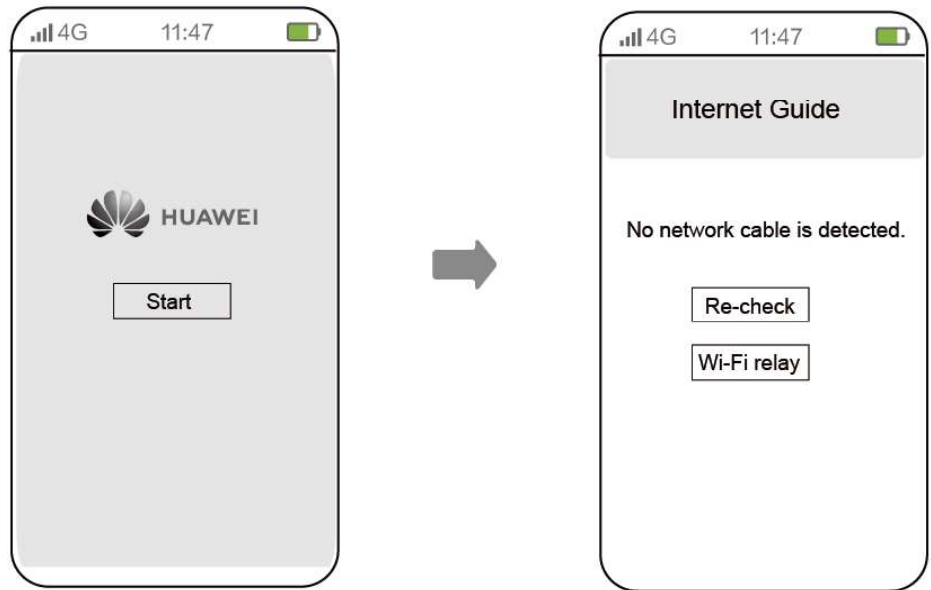

NOTE

1. Some mobile phones automatically display the configuration page following the Wi-Fi connection page.
2. If the configuration page is not automatically displayed, enter the IP address in the address box of a browser. (For details about the IP address, see the product nameplate.)
3. Select the Wi-Fi name to be connected, enter the Wi-Fi password, and click **Next**.



4. Set the administrator login password. You can use the Wi-Fi password as the device management password. Click **Next**. After the configuration is complete, reconnect to Wi-Fi.

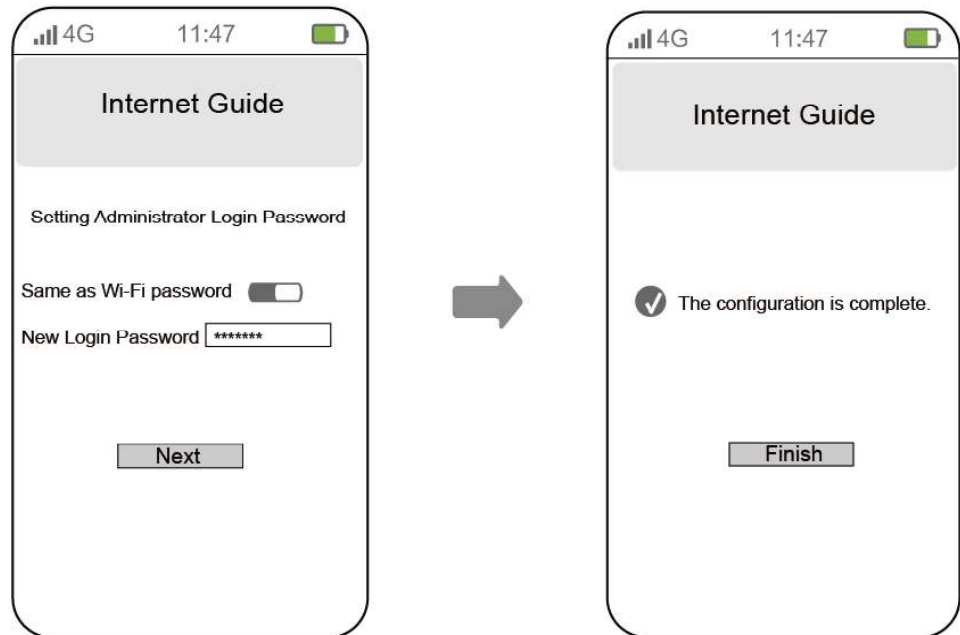

NOTE

1. The Wi-Fi name and password of the edge ONT are automatically synchronized from the Wi-Fi selected in [3.Select the Wi-Fi name](#)
2. You can connect devices such as PCs to network ports of the edge ONT using network cables to access the Internet.

4 Parameter

Item	Specification
System power supply	See the nameplate on the device.
Power adapter input	See the nameplate on the adapter.
Max power consumption	7.8 W
Ambient temperature	0°C to 40°C (32°F to 104°F)
Ambient humidity	5%–95% (non-condensing)
Dimensions (H x W x D) (Without pads)	65.5 mm x 105 mm x 105 mm
Weight (Without power adapter)	About 195 g

5 FAQs

What can I do if a problem occurs when I set the Internet access mode?

You can check the indicator status of the WA8021V5. If the indicator is steady red, Internet access is unavailable.

1. Cannot find the Wi-Fi of the edge ONT: Ensure that the device is powered on. Wait for a moment. After the device is started, scan for the Wi-Fi again.
2. Cannot access the configuration page: Ensure that the mobile phone is connected to the Wi-Fi network of the device and enter the IP address in the address box of a browser. (For details about the IP address, see the product nameplate.)
3. Cannot access the Internet after the settings: Ensure that the home gateway connected to the device can access the Internet. If a network cable is connected, ensure that network cable is connected securely.

How to restore the factory settings of an edge ONT?

Press and hold the Reset button of the device for more than 2 seconds using a needle, and release the button after the indicator turns off. After the device restarts and the red indicator turns on, the factory settings are restored.

NOTE

After the device is restored to factory settings, the device configuration parameters are cleared and need to be reconfigured.

Does the edge ONT support 5G Wi-Fi? How to connect to the 5G Wi-Fi?

Yes. The device supports 5G Wi-Fi. By default, the 2.4G/5G Wi-Fi names are the same. The device automatically connects to an optimal frequency band. To fix the connection to the 5G frequency band, disable the Dual-Band Steering as follows:

1. Connect a mobile phone to the Wi-Fi network of the edge ONT.
2. Enter the IP address in the address box of a browser and press **Enter**. (For details about the IP address, see the product nameplate.)
3. On the displayed login page, enter the login password as prompted.
4. Choose **My Wi-Fi** and turn off **Dual-band Combination**. Then, two Wi-Fi names are displayed. Connect to the Wi-Fi with the suffix `_5G`.

How to change the Wi-Fi name and password of an edge ONT?

1. Connect a mobile phone to the Wi-Fi network of the edge ONT.
2. Enter the IP address in the address box of a browser and press **Enter**. (For details about the IP address, see the product nameplate.)
3. On the displayed login page, enter the login password as prompted.
4. Choose My Wi-Fi on the web page, and change the Wi-Fi name and password.

NOTE

1. If the Wi-Fi name and password are synchronized from those of a gateway or router, see the changing method described for the gateway or router.
2. If you forget the login password, restore the edge ONT to its factory settings and set the Internet access mode again.